

NWX Quick User Guide

(V1.3)

Hardware Specification

Rear Panel

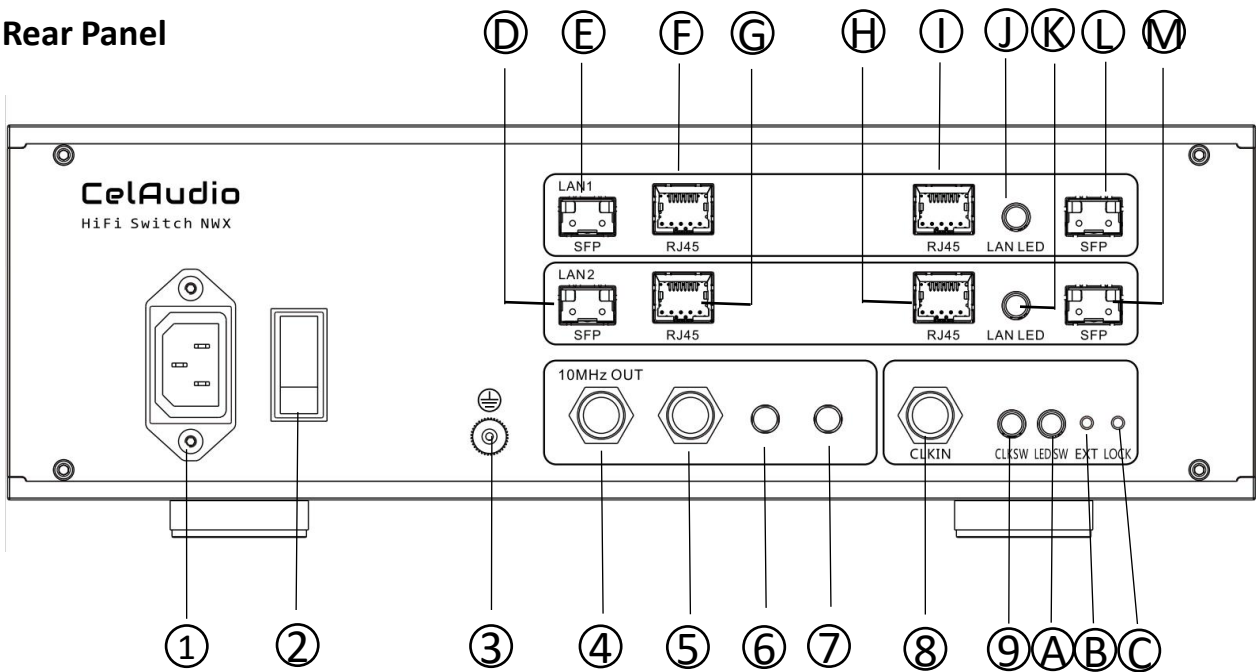

NWX rear panel ports:

1	Power Socket
2	Power Switch
3	Digital Ground
4/5	10MHz BNC Clock Output, 3.3V LVCMOS Standard
6/7	10MHz SMA Clock Output, 3.3V LVCMOS Standard
8	10M Reference Clock Input. Input Level $\geq 0.6V$ RMS
9	Clock Source Selection Switch. Press in to Select External Clock
A	Clock Source Indicator Light Switch. Press in for Normal Indicator Light, Otherwise the Indicator Light Turns Off
B	Clock Source Selection Indicator Light. Light On for External Clock, Light Off for Internal Clock
C	Clock Lock Status Indicator Light. Light On for Normal Lock
D/E/L/M	SFP Port
F/G/H/I	RJ45 Port
J/K	RJ45 Indicator Light Switch. Press in for Normal Indicator Light Display, Otherwise the Indicator Light Off

Typical Device Connection

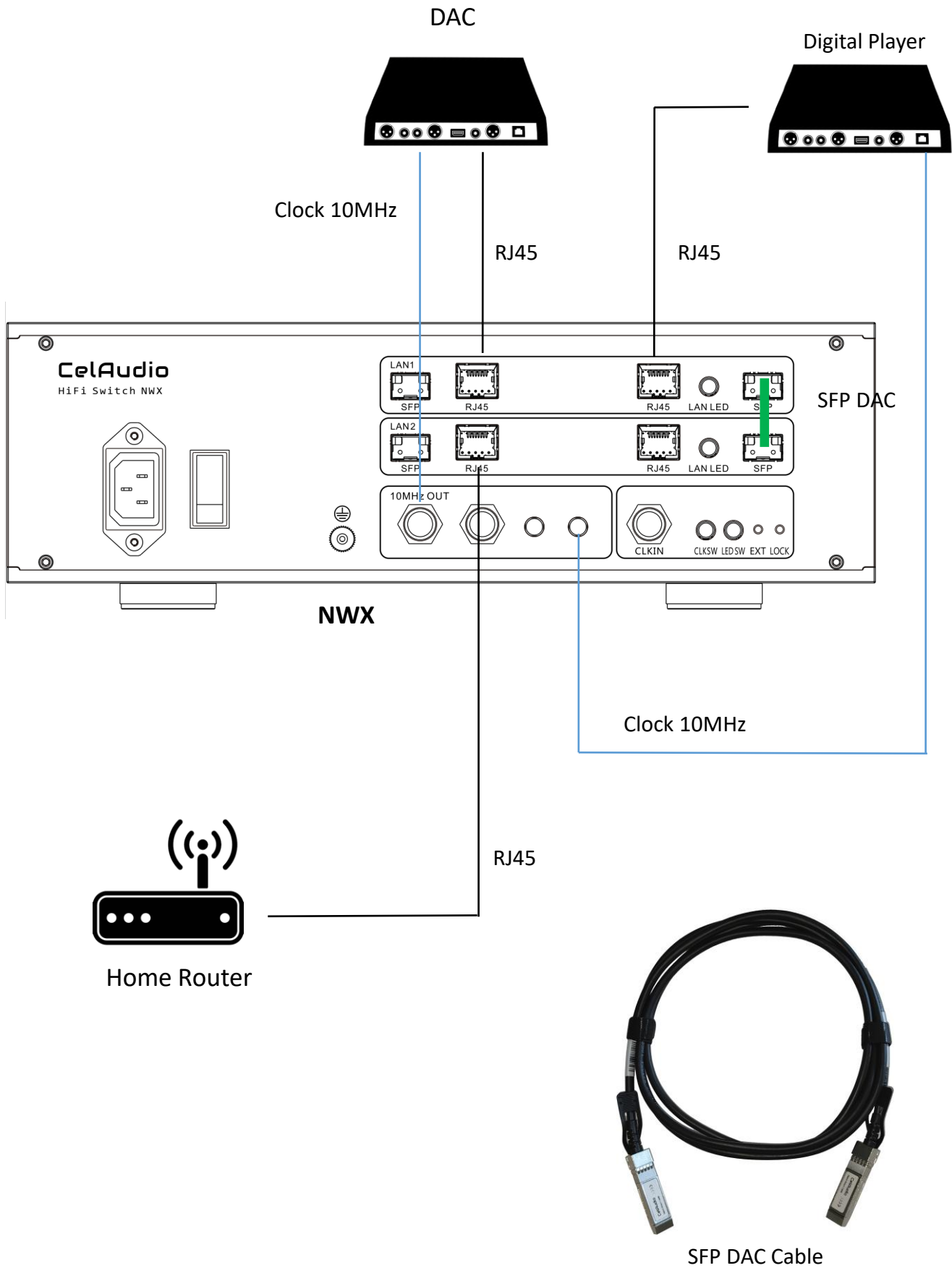

Purchase Methods/Channels of Cables and Connectors

SFP-DAC direct-attach cable: Please contact the Customer Service of CelAudio

NCK II network cable: Please contact the Customer Service of CelAudio

FS MMF Optical Transceiver Module : purchase link is <https://cn.fs.com/products/75332.html>

FS Industrial Transceiver Module : purchase link is <https://cn.fs.com/products/177946.html>

中性 (Generic) 兼容SGMII 10/100/1000BASE-T SFP工业级电口模块 100m RJ-45 (LOS)

P/N: SFP-GEB-T-IL

¥233.00

1.3K 销量 | 3 评价 | 2 问答

光模块型号:

SFP-GE-T | 100m

SFP-GEB-T-IL | 100m

SFP1G-SX-85-I | 550m

SFP1G-SX-31-I | 2km

SFP1G-LX-31-I | 10km

SFP1G-EX-31-I | 40km

SFP1G-ZX-55-I | 80km

兼容:

思科(Cisco)

瞻博(Juniper)

Arista

博科(Brocade)

HPE Aruba

华三(H3C)

戴尔(Dell)

迈络思(Mellanox)

HW

中性(Generic)

更多 +

定制

中性 (Generic) 兼容1000BASE-SX SFP多模光模块 850nm 550m DOM 双工LC/UPC

P/N: SFP1G-SX-85

¥35.00

96K 销量 | 1.9K 评价 | 24 问答

光模块型号:

SFP-GE-T | 100m

SFP-GEB-T | 100m

SFP1G-SX-85 | 550m

SFP1G-SX-31 | 2km

SFP1G-LX-31 | 10km

SFP1G-EX-55 | 40km

SFP1G-LH-31 | 40km

SFP1G-LX-31 | 20km

SFP1G-ZX-55 | 80km

兼容: ①

思科(Cisco)

瞻博(Juniper)

Arista

博科(Brocade)

惠普HP(ProCurve)

惠普HP(Aruba)

惠普HP(H3C)

华三(H3C)

戴尔(Dell)

中性(Generic)

更多 +

定制

Siemens Multimode Optical Fiber: Model is 6XV1843-5EH10-0AA0, and purchase link is <https://mall.siemens.com.cn/pcweb/detailIndex/52100022082.html>

SAMZHE OM2 Multimode Optical Fiber: Model is LC - LC ,and purchase link is <https://item.jd.com/100005857815.html>